

INDUSTRIAL / FLEX WAREHOUSE
Sale Price: \$17,000,000
Lease Rate: \$0.40/SF/NNN (Total Facility)
Property Highlights

Total Area	300,855 SF
Office Space	47,458 SF
Divisible	Minimum 30,000 SF for interim storage*
Ceiling Height	28'
Sprinkler System	ESFR
Construction	Concrete Tilt Up
Zoning	I-1
Loading	30 docks, 2 Grade
Power	3 Phase 277/480V, 4000 amps
Age	1996
2016 Real Estate Taxes	\$244,254.03

* The current monthly NNN is \$.102/SF

Space Amenities

- Fully Fenced 18.5 Acre Site
- 359 Space Parking
- 130,080 SF Expansion Pad
- 52'6" x 60' Column Spacing
- I-1 Zoning, City of Tucson

Smaller space is available for interim storage upon request.



For more information, please contact:

Rob Glaser, CCIM, SIOR
Principal, Industrial Properties
+1 520 546 2707
rglaser@picor.com

Max Fisher
Industrial Properties
+1 520 546 2709
mfisher@picor.com

Brandon Rodgers, CCIM
Principal, Industrial Properties
+1 520 546 2714
brodgers@picor.com

PICOR Real Estate Services
1100 N. Wilmot, Suite 200
Tucson, Arizona 85712
phone: +1 520 748 7100

Site Plan

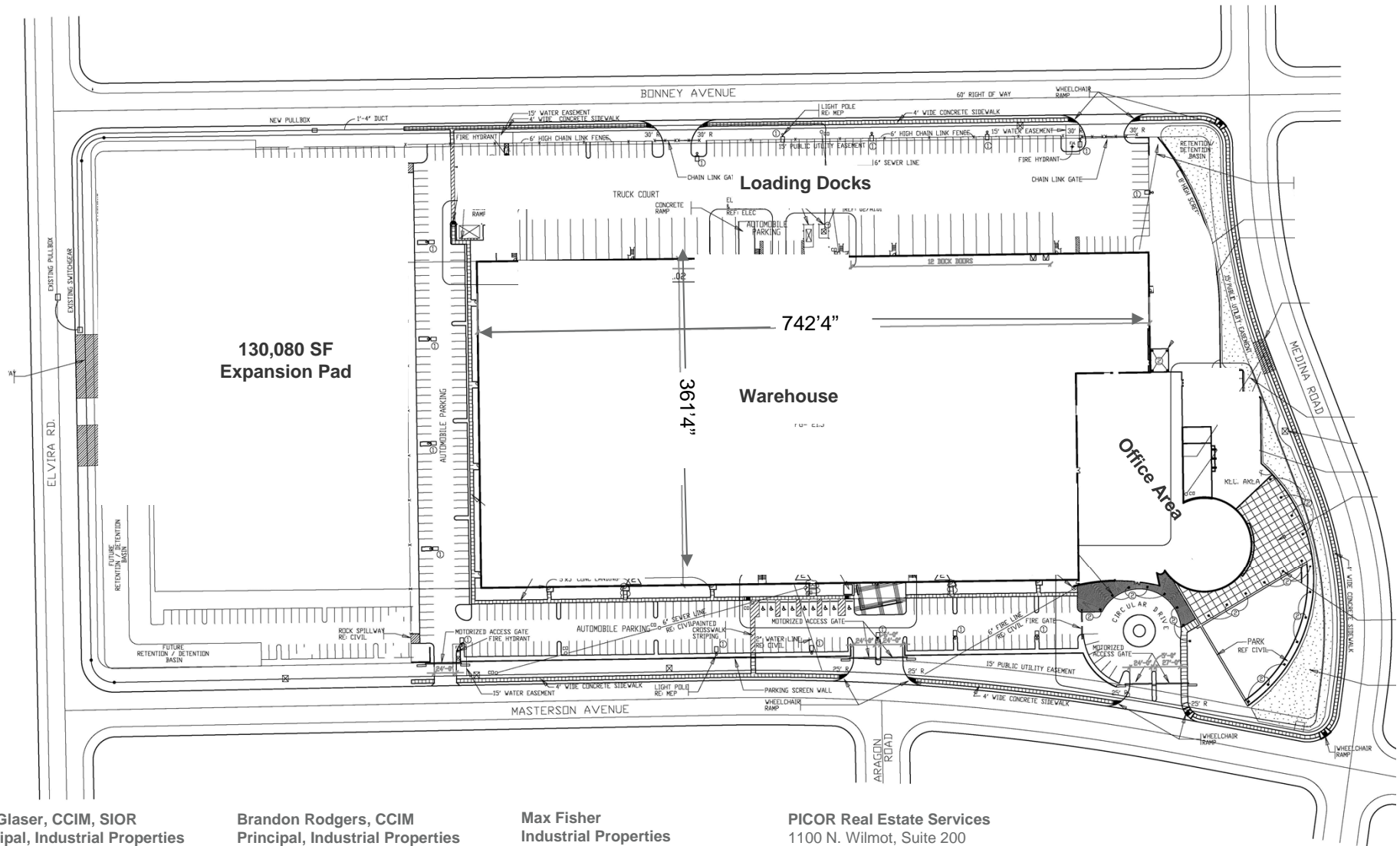

Rob Glaser, CCIM, SIOR
Principal, Industrial Properties
+1 520 546 2707
rglaser@picor.com

Brandon Rodgers, CCIM
Principal, Industrial Properties
+1 520 546 2714
brodgers@picor.com

Max Fisher
Industrial Properties
+1 520 546 2709
mfisher@picor.com

PICOR Real Estate Services
1100 N. Wilmot, Suite 200
Tucson, Arizona 85712
phone: +1 520 748 7100
picor.com

Independently Owned and Operated / A Member of the Cushman & Wakefield Alliance

Cushman & Wakefield Copyright 2016. No warranty or representation, express or implied, is made to the accuracy or completeness of the information contained herein, and same is submitted subject to errors, omissions, change of price, rental or other conditions, withdrawal without notice, and to any special listing conditions imposed by the property owner(s). As applicable, we make no representation as to the condition of the property (or properties) in question.

FOR SALE OR LEASE

6760 S. Lisa Frank Avenue

Tucson, AZ 85756

Floor Plan – 1st Floor Office

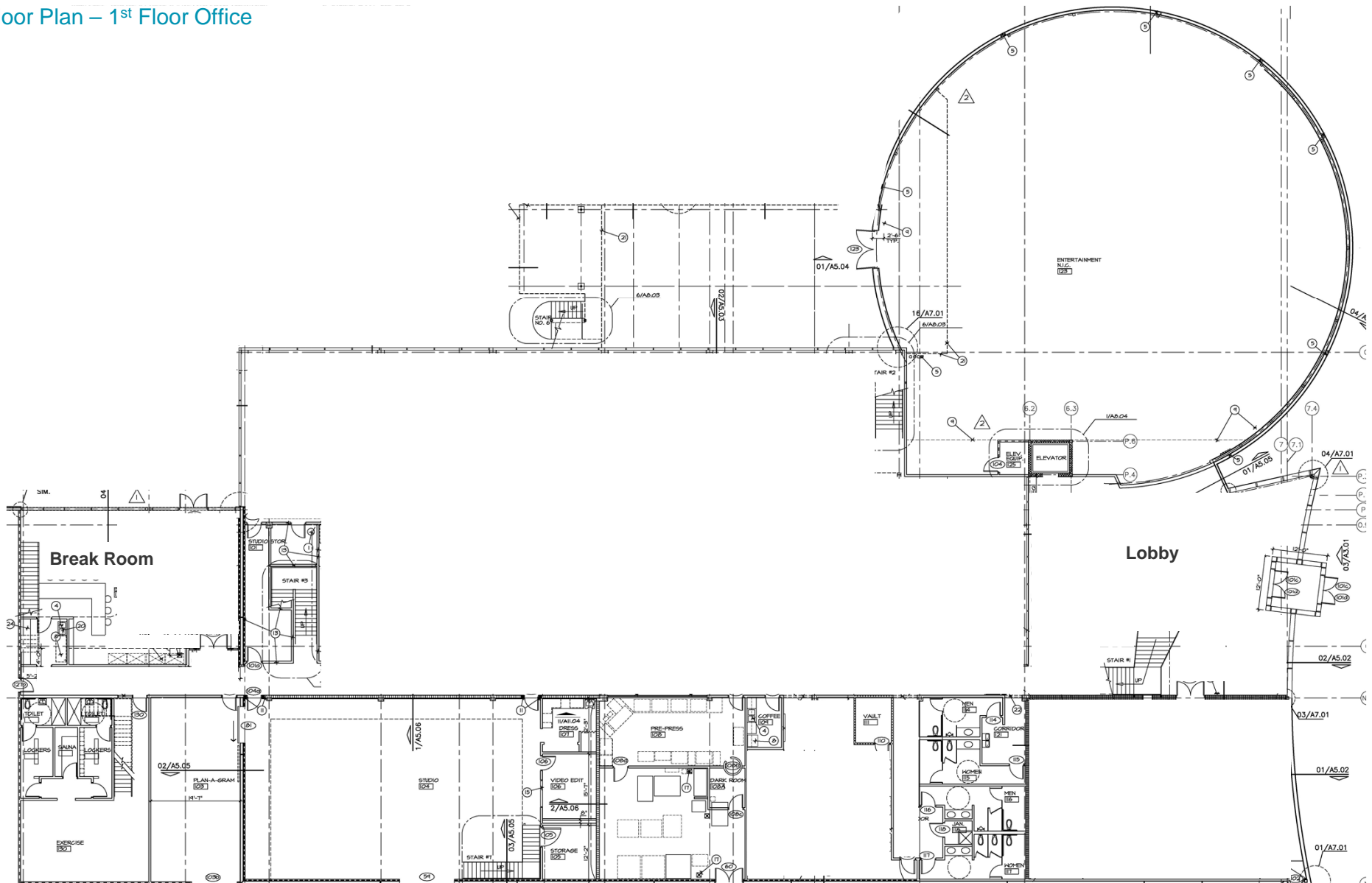

Independently Owned and Operated / A Member of the Cushman & Wakefield Alliance

Cushman & Wakefield Copyright 2016. No warranty or representation, express or implied, is made to the accuracy or completeness of the information contained herein, and same is submitted subject to errors, omissions, change of price, rental or other conditions, withdrawal without notice, and to any special listing conditions imposed by the property owner(s). As applicable, we make no representation as to the condition of the property (or properties) in question.



Cushman & Wakefield Copyright 2016. No warranty or representation, express or implied, is made to the accuracy or completeness of the information contained herein, and same is submitted subject to errors, omissions, change of price, rental or other condition, withdrawal without notice, and to any special listing conditions imposed by the property owner(s). As applicable, we make no representation as to the condition of the property (or properties) in question.

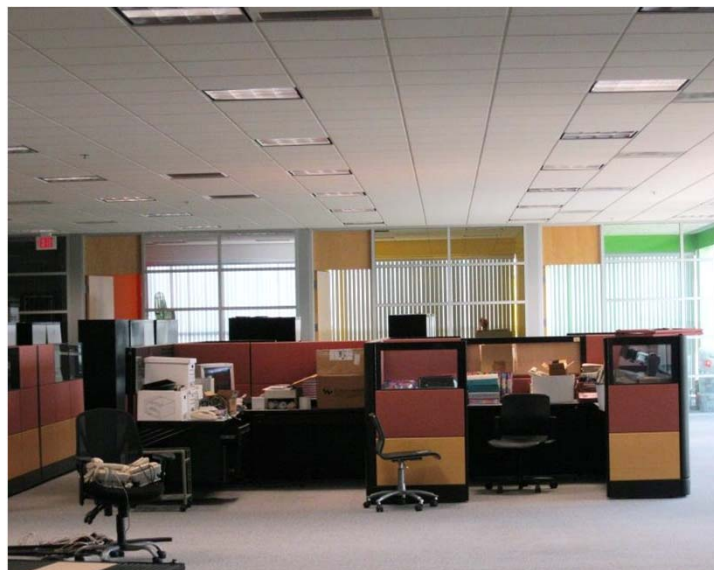
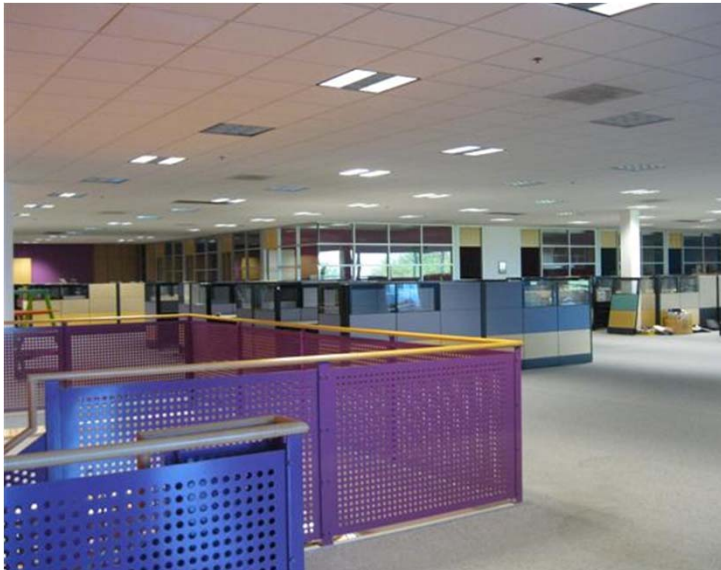

Rob Glaser, CCIM, SIOR
Principal, Industrial Properties
+1 520 546 2707
rglaser@picor.com

Brandon Rodgers, CCIM
Principal, Industrial Properties
+1 520 546 2714
brodgers@picor.com

Max Fisher
Industrial Properties
+1 520 546 2709
mfisher@picor.com

PICOR Real Estate Services
1100 N. Wilmot, Suite 200
Tucson, Arizona 85712
phone: +1 520 748 7100

picor.com



Rob Glaser, CCIM, SIOR
Principal, Industrial Properties
+1 520 546 2707
rglaser@picor.com

Brandon Rodgers, CCIM
Principal, Industrial Properties
+1 520 546 2714
brodgers@picor.com

Max Fisher
Industrial Properties
+1 520 546 2709
mfisher@picor.com

PICOR Real Estate Services
1100 N. Wilmot, Suite 200
Tucson, Arizona 85712
phone: +1 520 748 7100

picor.com

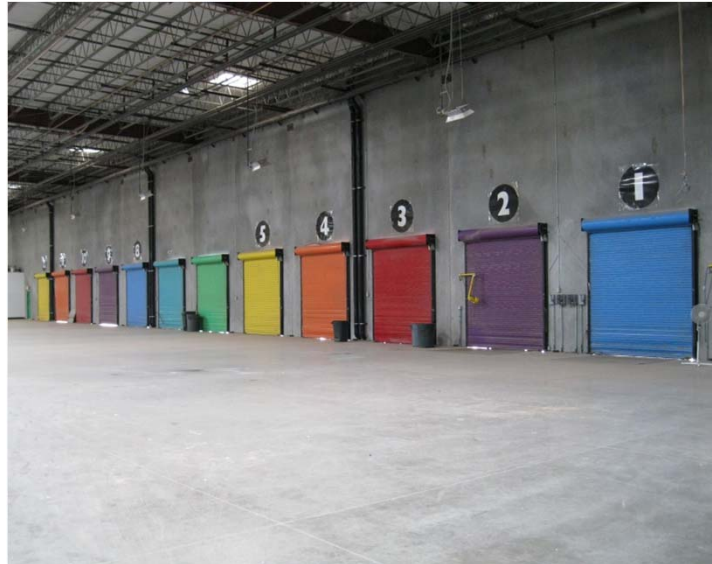

Rob Glaser, CCIM, SIOR
Principal, Industrial Properties
+1 520 546 2707
rglaser@picor.com

Brandon Rodgers, CCIM
Principal, Industrial Properties
+1 520 546 2714
brodgers@picor.com

Max Fisher
Industrial Properties
+1 520 546 2709
mfisher@picor.com

PICOR Real Estate Services
1100 N. Wilmot, Suite 200
Tucson, Arizona 85712
phone: +1 520 748 7100

picor.com

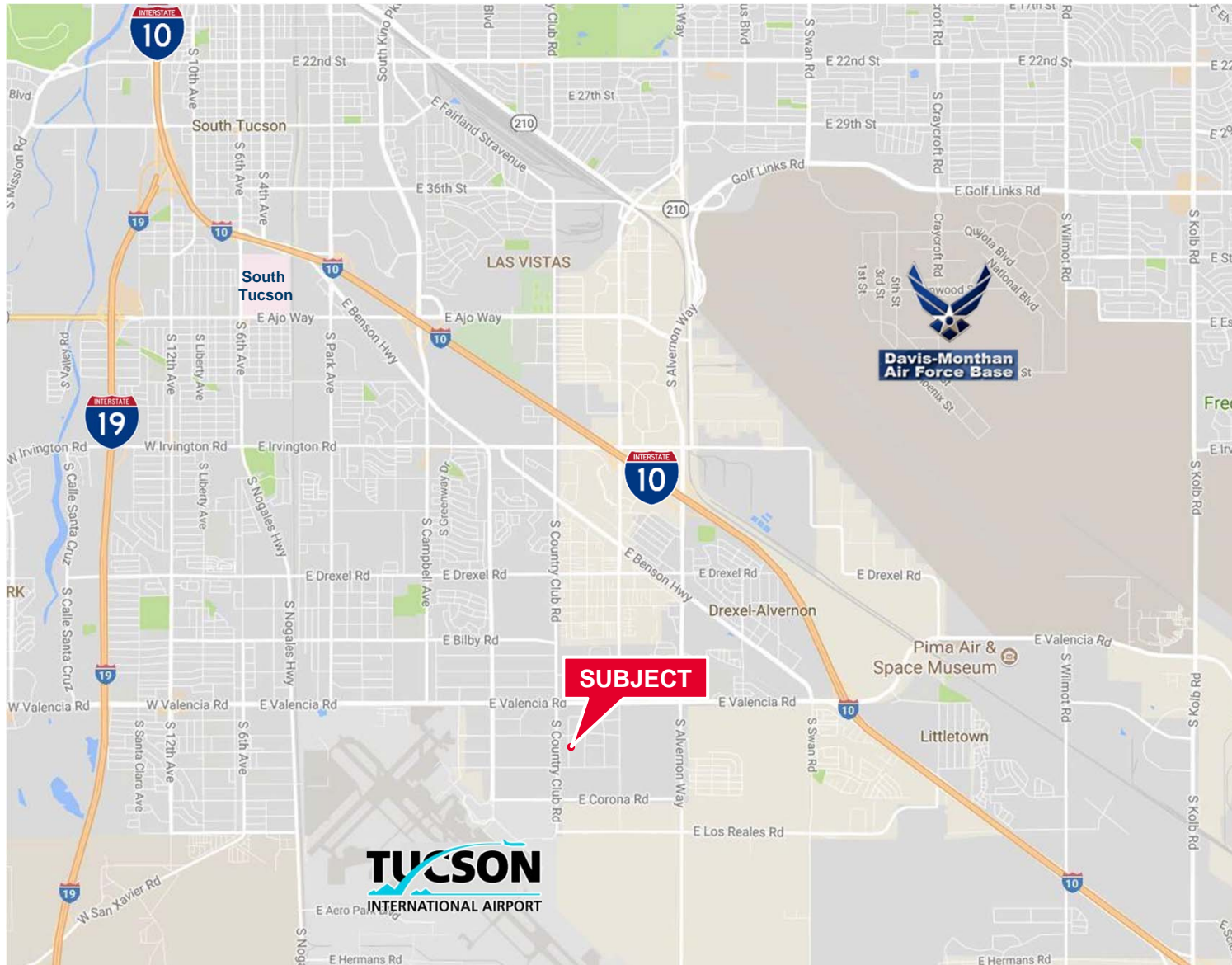

Tucson Map

Rob Glaser, CCIM, SIOR
Principal, Industrial Properties
+1 520 546 2707
rglaser@picor.com

Brandon Rodgers, CCIM
Principal, Industrial Properties
+1 520 546 2714
brodgers@picor.com

Max Fisher
Industrial Properties
+1 520 546 2709
mfisher@picor.com

PICOR Real Estate Services
1100 N. Wilmot, Suite 200
Tucson, Arizona 85712
phone: +1 520 748 7100

picor.com